

Three Circuit Mains Voltage Track

GLOBAL T



GLOBAL T

Global T track system is designed for easy surface or recessed mounting.

- Power supply can be taken into straight, L, T and X connectors.
- Easy wiring access for power cable
- Accessories designed in modular dimensions to permit exact squares and rectangles
- Tracks are supplied complete with punched fixing slots

GLOBAL T - SURFACE TRACK

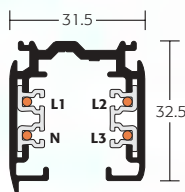

1.0m	2.0m	3.0m
XTS4100	XTS4200	XTS4300

GLOBAL T - RECESSED TRACK

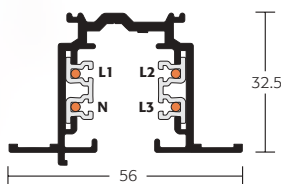
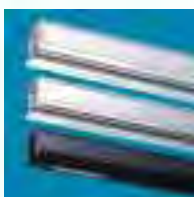

1.0m	2.0m	3.0m
XTSF4100	XTSF4200	XTSF4300

COLOURS

To specify colour add appropriate suffix to above codes eg. **XST4100-3**

White	Black	Anodised Aluminium
-3	-2	-1

Red line indicates earth



USE OF L- AND T- ACCESSORIES

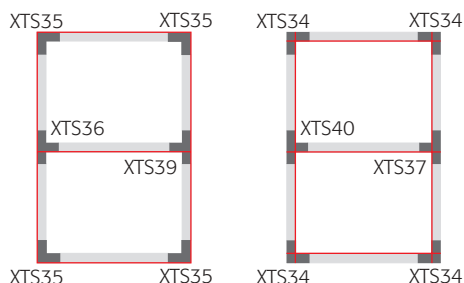

SUSPENSION DEVICES

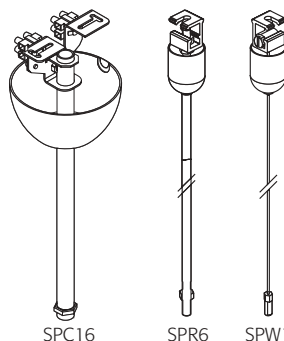

SPC16 - Conduit Suspension Set
Ø16 x 1000mm, 200N max.

SPR6 - Rod Suspension Set
M6 x 1000mm, 200N max.

SPW1 - Wire Suspension set
Terminal M6 x 1500mm,
150N max.

The *Global T* professional 3 circuit lighting system provides the ultimate in flexibility and ease of use. Global track is the most popular system in Europe, used extensively in shops, department stores, offices, museums and showrooms etc.

Global Trac® is a registered trademark of Nordic Aluminium PLC.

GLOBAL T 3-CIRCUIT LIGHTING TRACK SYSTEM

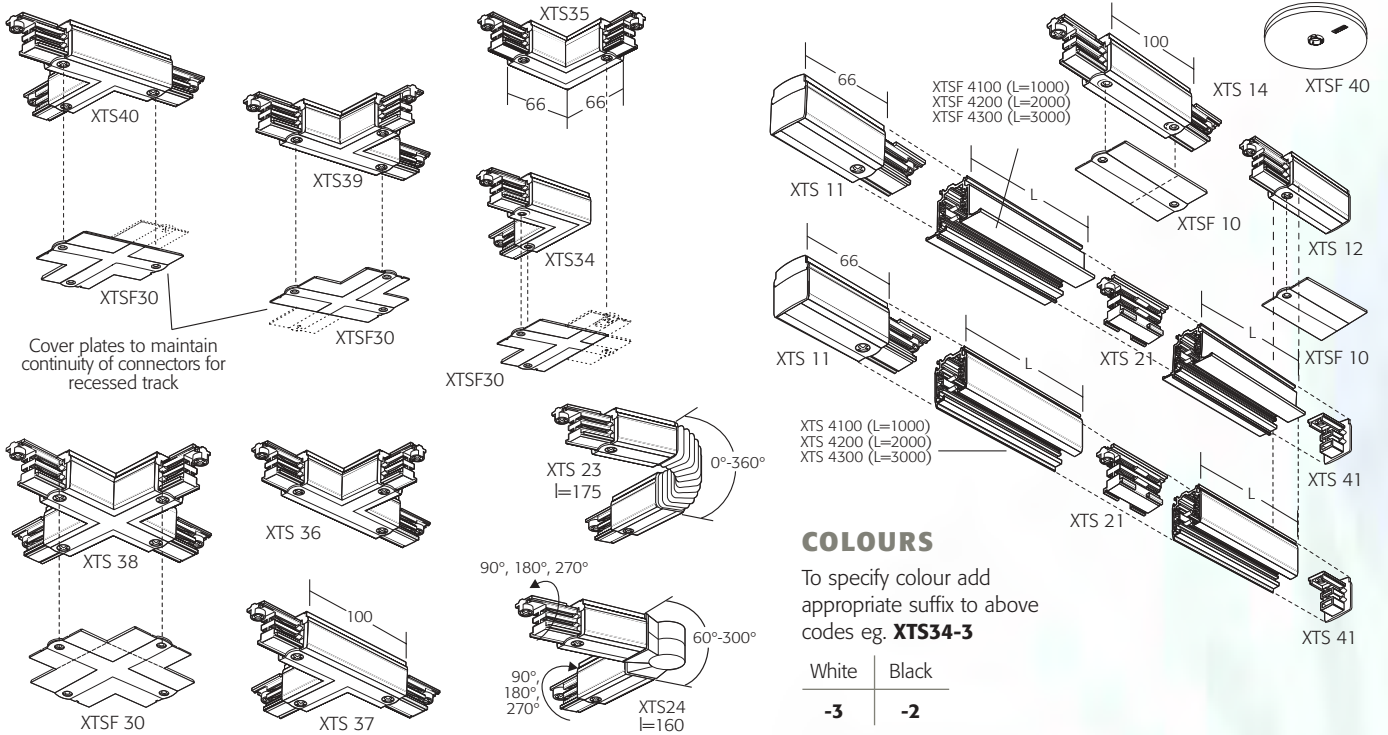

MOUNTING ACCESSORIES

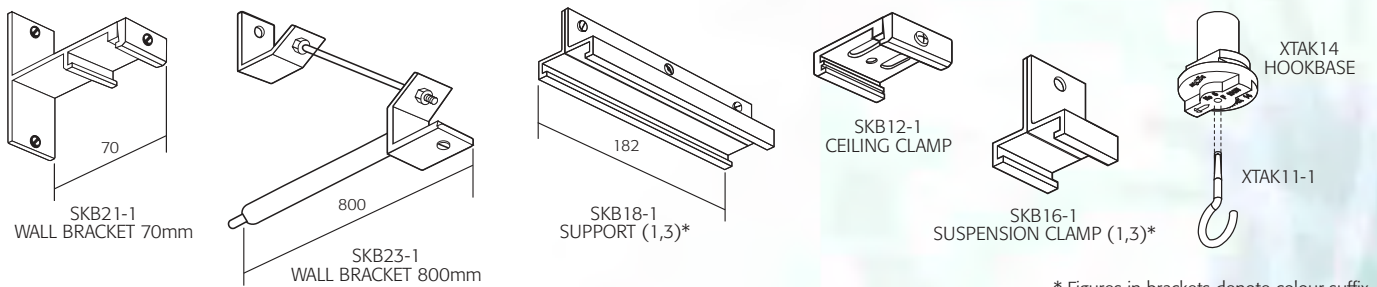

* Figures in brackets denote colour suffix

SUSPENSION PARTS

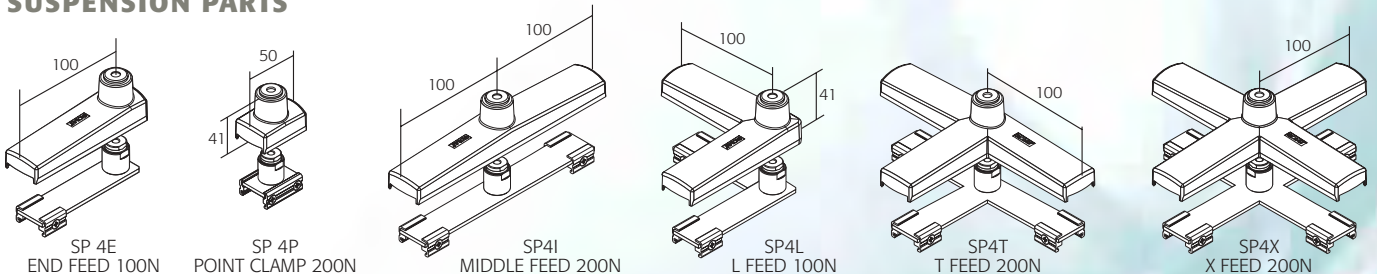

OPTIONS

Low Voltage Track
 Global S Track

PAGE

26 - 27
 28 - 29

FOR SALES AND INFORMATION:

TEL: +45 36 72 22 00 EMAIL: mail@elthermo.dk
 FAX: +45 36 41 07 41 WEB: www.elthermo.dk